

RH102 Accelerometer Technical Specification

1 Features

- Built-in IEPE circuit, isolation output, constant flow source power supply.
- Laser seal welded.
- Using military connector, can be used for the on-site industrial on-line monitoring with bad environment.

2 Pictures

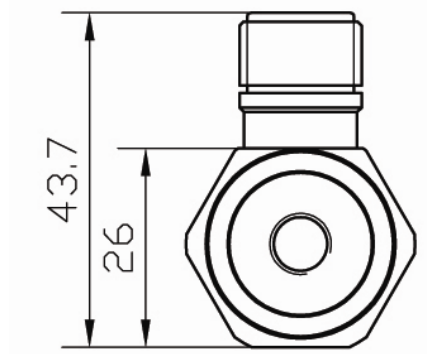
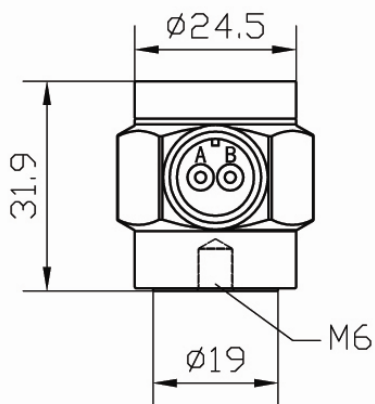

3 Technical Index

Parameters	Index	Remark
Basic parameters		
Sensitivity ($\pm 10\%$)	100mv/g	
Range	$\pm 80g$	
Linearity	1%	
Frequency Response ($\pm 10\%$)	0.7~10000Hz	
Frequency Response(± 3 dB)	0.4~15000Hz	

Resonance Frequency	26KHz	
Transverse Sensitivity	≤5%	
Electrical character		
Bias Voltage	10.5-13.5VDC typical: 12VDC	
Constant Current	2-20mA Typical: 4mA	
Excitation Voltage	18-30VDC typical: 24VDC	
Settling time	≤2S	
Electrical noise power spectral density	10Hz 14 μg/√Hz 100Hz 5 μg/√Hz 1000Hz 3 μg/√Hz	
Output Impedance	<100Ω	
Casting Dielectric Resistance	>10 ⁸ Ω	
Features		
Maximal Shock Level	5000g	
Mounting Thread	6mm	
Weight	92g	
Dimension	Diameter × Height: 23×32 (mm)	
Seal Method	Laser Welding	
Protection Grade	IP68	
Casting Material	316L stainless steel	
Output	Side output, 2pins Mil-C-5015	
Working Temperature	-40~+120℃	
Mount Torque	About 2.7~6.8N.m (M6 thread)	
Certificates	CE	
Temperature Measuring (Not standard, optional)		
Measuring Range	-40~120℃	1.Model: RH102T
Sensitivity	10mv/℃	2.Side output, 3 pins Mil-C-5015
Explosion proof option		
Identification	ExiaIICT4	For Zone 0, 1, 2

Unconditional Lifetime Warranty

RONS reserves the right to make changes in this product catalogue.

ying.xie@ronds.com.cn

www.ronds.com.cn