

# USC-360N Series

## 15.6" Ultra-Slim, All-in-One Computer USC-360N with Intel® N150/Core 3 N355



### Features

- 15.6" FHD LCD (LED backlight) with PCAP Touch
- Sleek modern designed with compact single hinge stand
- Built-in Intel Twin Lake N series processor
- Rich peripherals for diverse applications
- Flexible installation for 2nd display
- Integrate multifunction via USB-C (video, audio, etc.)
- Support 75x75mm VESA
- Supports both landscape and portrait screen orientations
- Equipped with DeviceOn / iService software for remote device management

### Introduction

The USC-360 all-in-one service computer is the latest addition to Advantech's USC product family. Powered by an Intel® N150 and Core 3 N355 processor that be with the most competitive cost, and energy effective platform built for retail and hospitality. USC-360 computers feature an ultra-slim form factor to ensure easy installation in diverse environments. In addition to the 15.6" TFT LCD monitor with IP65-rated front panel that protects against water and dust ingress, USC-360 can be equipped with an optional secondary display for broadcasting product promotions and increasing consumer engagement. Overall, USC-360 computers provide flexible point-of-service (POS) computing solutions that enable retailers and service staff to optimize operations and improve customer service.

### Specifications

Model	USC-360N	
Processor	Intel Twin lake N155/Core 3 N355	
Memory	1 x 260-pin SODIMM DDR5-4800 (Up to 16GB)	
Storage	1 x M.2 M-Key 2280 SSD	
Display	15.6" TFT LCD (1920*1080), 220nits (350nits optional)	
Touch screen	Projected capacitive (P-CAP) touch control (Flat glass)	
USB	3 x USB-C, 2 x USB 3.0, 4 x USB 2.0 (2*side)	
Audio	2 x 2W speaker installed	
Power supply	65W via power adaptor	
Bus Expansion	1 x M.2 2230 E-Key for Wi-Fi&BT combo	
Ethernet	1 x RJ-45 2.5G LAN Ethernet	
Operation System	Windows 10/11, Linux	
Cash Drawer	1 x Cash drawer port, 12V	
USB-C Input	20 V <sub>DC</sub>	
IP rating	IP65 for front panel	
Dimensions(WxHxD)	381 x 230.4 x 31.5 mm	
Weight	4.2Kg (Net); 4.8Kg (Gross)	
Color	Black (White optional)	
TPM	Support TPM 2.0	
Operating Temperature	0~40°C/32~104°F	
Storage Temperature	-40°C, 60°C @95% humidity	
Relative Humidity	95% RH Max @40°C non-condensing	
Shock	10G peak acceleration (11 ms duration)	
Vibration	5~500 Hz 0.5 Grms, random	
Certification	FCC, CE, CE RED, CCC, BSMI, UL, CB	
DeviceOn/iService Remote Device Management Software	Operating System	Windows 11, Linux
	Common Controls (Reboot, Shutdown)	✓
	Remote Desktop	✓(VNC)
	Audio Controls	✓
	Connection Status	✓
	Hardware Status	✓
	Hard Disk Status	✓
	Batch Operation Support	✓
	OTA Storage Management	FTP
	OTA Software Updates	✓
	Software Watchlist	✓
	Software Start/Stop	✓
	Peripherals Watchlist	✓

## Outlook



Extension IO integrated via stand



Supports 75x75 VESA mounting



Integrate devices via USB-C



Single hinge stand + Dual display

## Dimensions

Unit: mm

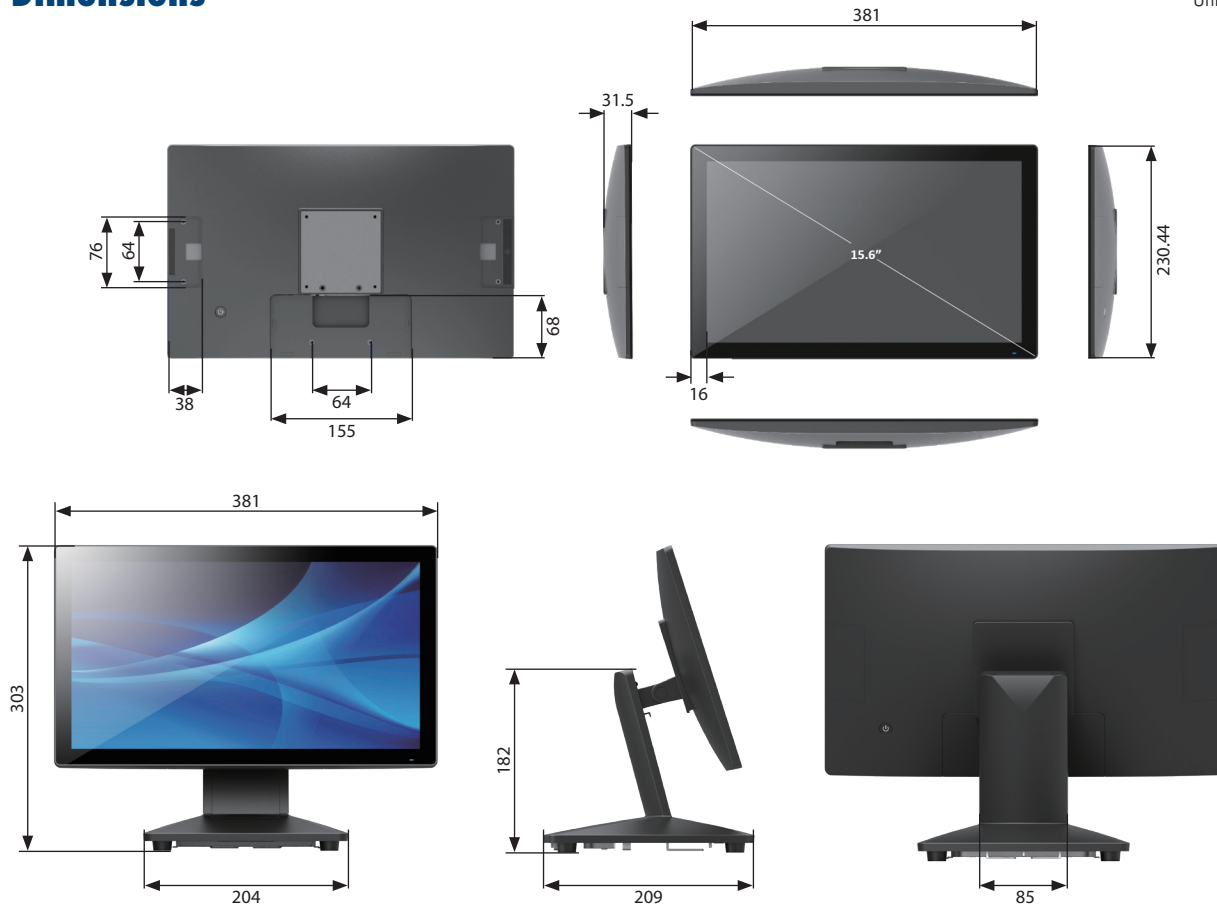

## Ordering Information

Part number	Description
USC-360NP-BN155	15.6", PCAP, N150, 8G, 128G, W/Stand, Black
USC-360NP-BI355	15.6", PCAP, N355, 8G, 128G, W/Stand, Black

## POS Peripherals

PN	Description
USC-P05-B300	Barcode Scanner for USC-360 portrait, USB interface, Black
USC-P05-B301	Barcode Scanner for USC-360 IO side, USB interface, Black
USC-P03-B304	MSR007GH for USC-360, USB interface, Black
USC-P03-B300	5M Camera for USC-360, USB interface, Black
USC-P03-B301	RFID Scanner for USC-360, USB interface, Black
USC-P03-B302	LED LIGHT BAR for USC-360, GPIO interface
USC-P03-B303	Finger Print Reader for USC-360, USB interface, Black
USC-P01-B201	VFD, English, 2*20, Rear Mount, USB interface, Black
USC-M10G-BTC05	10.1" monitor, glass, black, rear hinge, USBC
USC-M10P-BTC05	10.1" monitor, PCAP,black, rear hinge, USBC
USC-M15WP-BST16	15.6" monitor, PCAP,black, rear hinge, USBC
USC-P06-H02	USC-300 series UP37 extension hub, 4C6U (Powered by USC-360 65W adapter)
USC-P06-H01	USC-365 series UP36 extension hub (powered by 180W adapter)
XUSC365-ADP180WBB	ADP A/D 100-240V 180W 24V POWER DIN 4PIN (Powered for USC-P06-H01+USC-360 series)

## Installation Accessories

Part number	Description
USC-360P-WB0E	USC-360H/J M.2 (159),WF5+ BT 2.4/5GHz M.2 2230
96CB-POWER-B-1.8MB	Power cable 3P, CCC, 10A, 250V, 180 cm (China)
1700001524	Power cable 3P, UL, 10A, 125V, 180 cm (US, TW)
170203183C	Power cable 3P, 10A, 250V, 183 cm (EU)
1700018553	Power cable 3P, SAA, 2.5A, 250V, 183 cm (Australia)
1700018409	Power cable, KCC, 2P, 2.5A, 250V, 183 cm (Korea,Russia)
170203180A-01	Power cable, BSI, 3P, 2.5A, 250V, 183 cm (UK)
1700008921	Power cable, PSE, 3P, 7A, 125V, 180 cm (Japan)

## Operating System

Part number	Description
20708WLE1S0027	Img WIN11 LTSC_24H2_ELE USC-360N V1.00 7MUI
20708U22DS0008	Ubuntu 22.04 V1.0.2

## I/O Layout

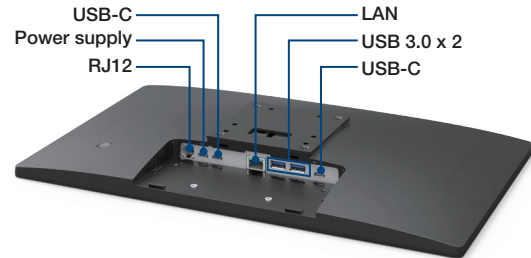

## Side I/O



## Stand I/O

